



PREMIUM AFTERMARKET WIND DEFLECTORS

Chrysler Sebring / Lancia Flavia wind deflector fitting instructions

Product No: 08.15.01.01 (BLACK)

Product No: 08.15.01.01 (BEIGE)



Product No: 37.13.01.04 (GREY)



What is in the box

- 1 x Wind deflector
- 1 x Installation manual

STEP 1

Open the top and fold both front seats forward.



PREMIUM AFTERMARKET WIND DEFLECTORS

STEP 2

Slide the rear brackets of the wind deflector under the rear headrests.



PREMIUM AFTERMARKET WIND DEFLECTORS

STEP 3

Unlock the side pins and guide them into the factory fitted wind defectors mounts.

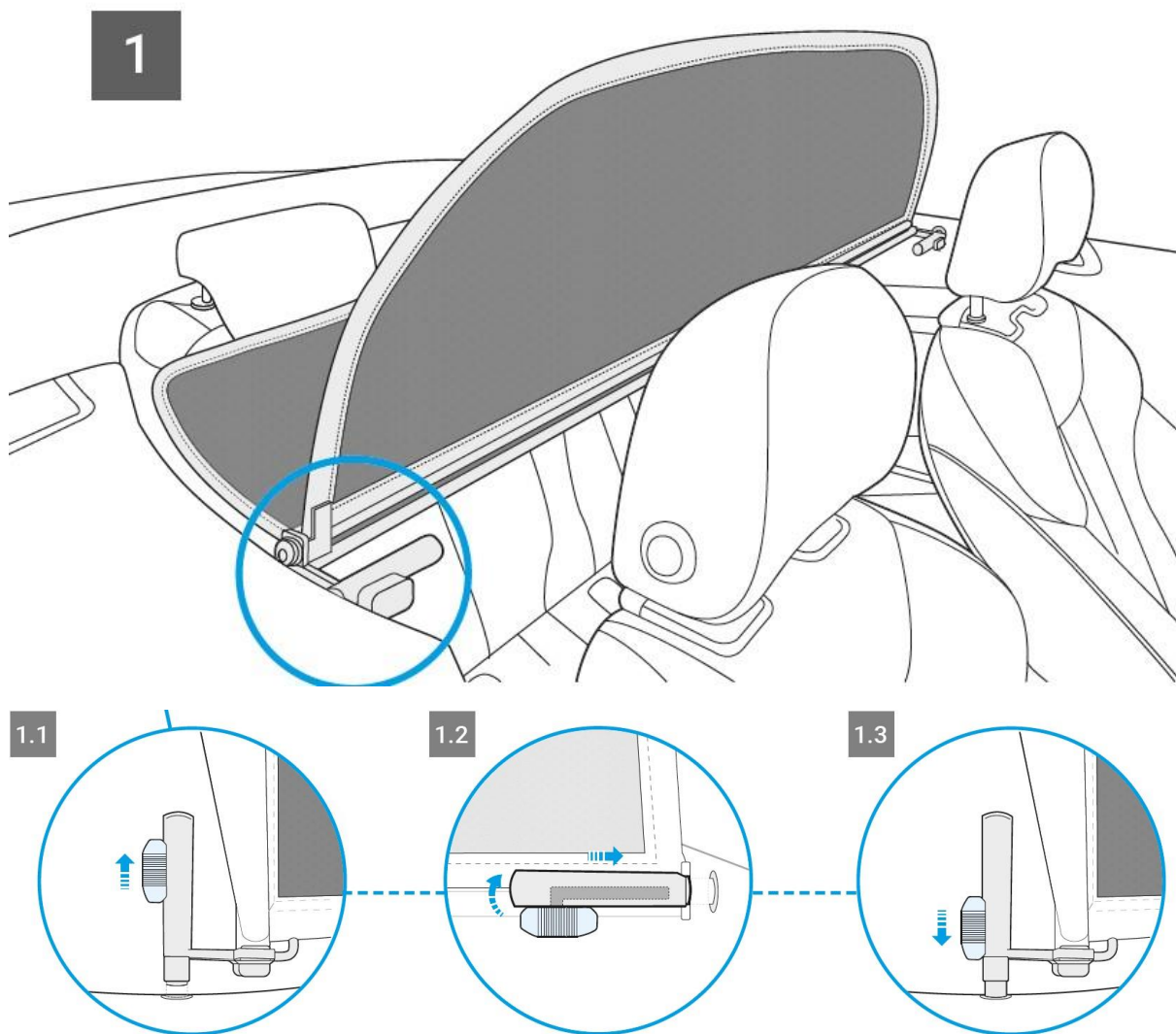



PREMIUM AFTERMARKET WIND DEFLECTORS



STEP 4

Go out for a test drive and enjoy you APERTA wind deflector!